

Portable **Elcometer High Volume Air Distribution Manifolds (ADM)** are designed to maintain a consistent air supply to multiple air powered devices.

- Heavy duty ¼" (6mm) construction steel thickness
- Supplied with plug as standard
- Supply up to 6 different air powered devices
- Inbuilt moisture trap & baffle separates moisture from air supply
- Designed for use with air compressors, up to a maximum working pressure of 217psi (15bar)
- Built-in lifting lugs and wheels for easy manoeuvring around site



When connecting multiple air powered devices to a single compressor, the demands on air flow can vary as each device switches on or off. An **Air Distribution Manifold (ADM)** can **reduce fluctuations** in demand, acting as a buffer, to provide a **more consistent air supply to multiple devices**.



	ADM75	ADM150	ADM300
--	-------	--------	--------

Capacity	2.6cu ft (75 litres)	5.3cu ft (150 litres)	10.6cu ft (300 litres)
Pot Diameter	13 ⁹ / ₁₀ " (353mm)	19 ⁷ / ₈ " (492mm)	23 ³ / ₈ " (604mm)
Height	45 ¹ / ₂ " (1155mm)	45 ¹ / ₂ " (1155mm)	53 ³ / ₈ " (1365mm)
Width	26 ¹ / ₁₀ " (663mm)	30" (762.3mm)	33 ³ / ₁₀ " (846mm)
Weight	90kg (198.4lb)	125kg (275.6lb)	205kg (452lb)
Air Inlet	1 x 2" (50.8mm)	1 x 2" (50.8mm)	1 x 3" (76.2mm) ¹
Number of Air Outlet Points	5	5	6
Air Outlet Dimensions	1 x 2" (50.8mm) ² 4 x 1 ¹ / ₄ " (31.75mm)	1 x 2" (50.8mm) ² 4 x 1 ¹ / ₄ " (31.75mm)	2 x 2" (50.8mm) ² 4 x 1 ¹ / ₄ " (31.75mm)
Pressure Relief Valve Outlet	1 x 1" (25.4mm) ³	1 x 1" (25.4mm) ³	1 x 1" (25.4mm) ³
Drain Outlet	1 x 3/4" (19mm) Ball Valve	1 x 3/4" (19mm) Ball Valve	1 x 3/4" (19mm) Ball Valve
Max Working Pressure (WP)	217psi (15bar)	217psi (15bar)	217psi (15bar)
Operating Temperature Range	32 to 140°F (0 to 60°C)	32 to 140°F (0 to 60°C)	32 to 140°F (0 to 60°C)

¹ With 3" (76.2mm) to 2" (50.8mm) removable reducing bush fitted
³ To fit Elcometer PRV, a 0.5" (12.7mm) reducing bush is required

² With 2" (50.8mm) to 1¹/₂" (38.1mm) removable reducing bush see page 7-5

Elcometer's Air Distribution Manifolds are designed with a range of features and benefits with the ability to connect **up to 6 different air powered appliances** at any one time, depending on the model.

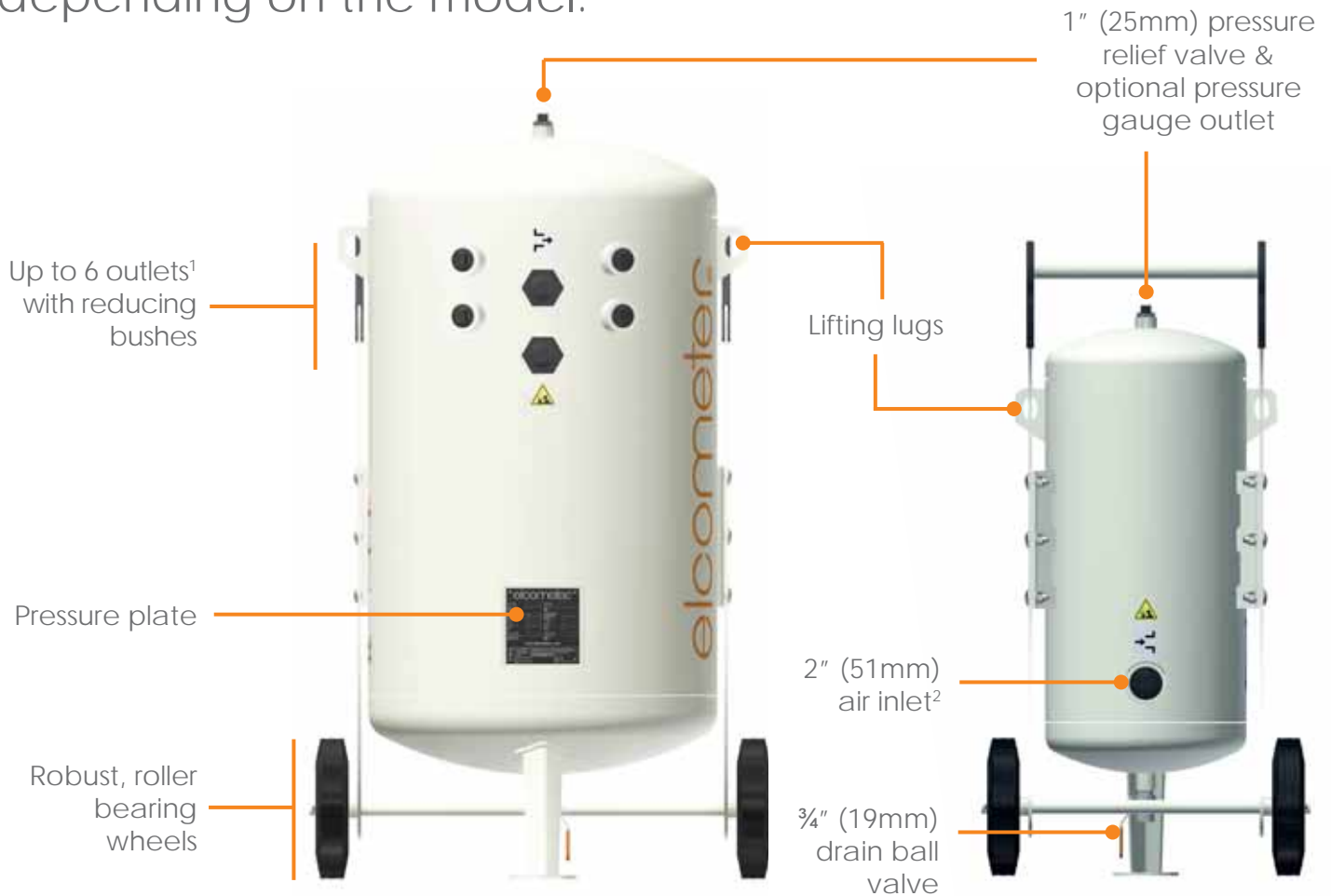

The Elcometer Air Distribution Manifold is supplied with plugs so that when an air outlet is not in use, the compressed air does not escape.

The ADM features a moisture separation system to ensure there is minimal moisture in the compressed air that is dispensed, this works by cooling the air so that the water particles are removed, the water then drips out of the adjustable ball valve exiting the air distribution manifold.

Part Numbers	
Part Number	Description
ADM75N	2.6cu ft (75 litre) Air Distribution Manifold with 5 outlets
ADM150N	5.3cu ft (150 litre) Air Distribution Manifold with 5 outlets
ADM300N	10.6cu ft (300 litre) Air Distribution Manifold with 6 outlets

¹ Amount of outlets dependent on model, see page 7-3 for more information

² Size of inlet dependent on model, see page 7-3 for more information



Certified Pressure Relief Valves

Pressure relief valves must be incorporated into the system to meet global safety standards. Elcometer's certified pressure relief valves can be easily fitted to your Elcometer air distribution manifold which is fitted to the RCV4000+ remote control valves. Pressure relief valves are designed to discharge the compressed air in the blast machine upon reaching the crack pressure.

Part Numbers

Part Number	Description
MT28606N	½" (13mm) Certified Pressure Relief Valve (12bar/174psi)
MT28607N	½" (13mm) Certified Pressure Relief Valve (15bar/217psi)
MT30199N	1" - ½" (25mm - 13mm) Male-Female Reducing Bush - required for pressure relief valve

Accessories

Part Number	Description
MT30537N	Pressure Gauge
MT30539N	Pressure Gauge Connection Assembly (includes Pressure Gauge, T Piece, Bush, Nipple and Plug)



Reducing Bushes

Elcometer offer a range of reducing bushes that are resistant to corrosion. The reducing bushes are quick and easy to install to your air distribution manifold.

Part Numbers

Part Number	Description
MT30180N	3" (76mm) - 2" (51mm) Male-Female Reducing Bush
MT30181N	2" (51mm) - 1½" (38mm) Male-Female Reducing Bush
MT30187N	2" (51mm) - 1¼" (32mm) Male-Female Reducing Bush
MT29707N	1½" (38mm) - 1" (25mm) Male-Female Reducing Bush
MT28595N	1½" (38mm) - ¾" (19mm) Male-Female Reducing Bush
MT30201N	1¼" (32mm) - 1" (25mm) Male-Female Reducing Bush
MT30541N	1¼" (32mm) - ¾" (19mm) Male-Female Reducing Bush
MT29685N	1" (25mm) - ¾" (19mm) Male-Female Reducing Bush
MT30199N	1" (25mm) - ½" (13mm) Male-Female Reducing Bush



Plugs

Designed to stop air leaving the outlets you are not currently using, Elcometer's plugs come in a range of sizes.

Part Numbers

Part Number	Description
MT30183N	2" (51mm) Plug
MT30182N	1½" (38mm) Plug
MT30184N	1¼" (32mm) Plug
MT29681N	1" (25mm) Plug
MT30099N	½" (13mm) Plug
MT28596N	¼" (6mm) Plug

Air Supply Ball Valves

Air supply ball valves are fitted between the air hose and the moisture separator to isolate the compressor when undertaking maintenance work. The valves disconnect the compressed air from the blast machine for safe work.

Part Numbers

Part Number	Description
MT30189N	3" (76mm) Male-Female Ball Valve
MT30191N	2" (51mm) Male-Female Ball Valve
MT29177N	1½" (38mm) Male-Female Ball Valve
MT30193N	1¼" (32mm) Male-Female Ball Valve
MT30195N	1" (25mm) Male-Female Ball Valve
MT28610N	¾" (19mm) Male-Female Ball Valve
MT28619N	¼" (6mm) Female-Female Ball Valve
MT30085N	¼" (6mm) Male Adaptor



Universal Coupling

Part Numbers

Part Number	Description
4 Claw Hose Couplings:	
MT30220	2" (51mm) 4 Claw Coupling
MT30219N	1½" (38mm) 4 Claw Coupling
2 Claw Hose Couplings:	
MT30543N	1¼" (32mm) 2 Claw Coupling
MT30222	¾" (19mm) 2 Claw Coupling



Elcometer 75L Air Distribution Manifold

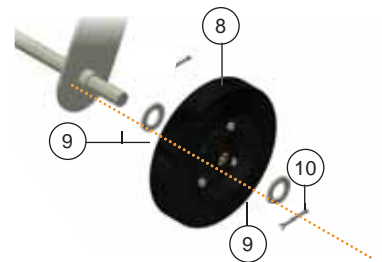

Spare Parts

Item	Part Number	Description
1	MT30181N	2" - 1½" Reducing Bush
2	MT30183N	2" Plain Plug Solid
3	MT30182N	1½" Plain Plug Solid
4	MT30184N	1¼" Plain Plug Solid (x4)
5	MT29681N	1" Plain Plug Solid
6	MT30095N	¾" (19mm) Ball Valve Handle
7	MT28610N	¾" (19mm) Ball Valve Assembly (includes MT30095N Ball Valve Handle)
8	MT28636	Ø250mm (9.8") Diameter Wheel (x1)
9	MT29697	Flat Washer (x4)
10	MT29698	Split Cotter Pin (x4)
11	MT29601	Protective Edging Strip Kit (2.7m) (8.9ft)
-	MT29180	Elcometer Safety Label Kit

Elcometer 150L Air Distribution Manifold

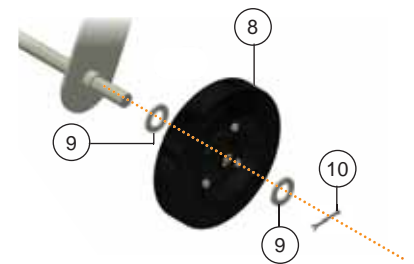

Spare Parts

Item	Part Number	Description
1	MT30181N	2" - 1½" Reducing Bush
2	MT30183N	2" Plain Plug Solid
3	MT30182N	1½" Plain Plug Solid
4	MT30184N	1¼" Plain Plug Solid (x4)
5	MT29681N	1" Plain Plug Solid
6	MT30095N	¾" (19mm) Ball Valve Handle
7	MT28610N	¾" (19mm) Ball Valve Assembly (includes MT30095N Ball Valve Handle)
8	MT28636	Ø250mm (9.8") Diameter Wheel (x1)
9	MT29697	Flat Washer (x4)
10	MT29698	Split Cotter Pin (x4)
11	MT29601	Protective Edging Strip Kit (2.7m) (8.9ft)
-	MT29180	Elcometer Safety Label Kit

Elcometer 300L Air Distribution Manifold



Spare Parts

Item	Part Number	Description
1	MT30180N	3" x 2" Reducing Bush
2	MT30181N	2" - 1½" Reducing Bush
3	MT30183N	2" Plain Plug Solid
4	MT30182N	1½" Plain Plug Solid (x2)
5	MT30184N	1¼" Plain Plug Solid (x4)
6	MT29681N	1" Plain Plug Solid
7	MT30095N	¾" (19mm) Ball Valve Handle
8	MT28610N	¾" (19mm) Ball Valve Assembly (includes MT30095N Ball Valve Handle)
9	MT28636	Ø250mm (9.8") Diameter Wheel (x1)
10	MT29697	Flat Washer (x4)
11	MT29698	Split Cotter Pin (x4)
12	MT29601	Protective Edging Strip Kit (2.7m) (8.9ft)
-	MT29180	Elcometer Safety Label Kit